

The 1<sup>st</sup> True Double Glazed  
Sashless Window



aneeta<sup>®</sup>  
A JELD-WEN Company

## Clearstep

Double Glazed Sashless  
Double Hung Window



### **A double glazed window built in a sashless way.**

Clearstep provides all the benefits of traditional double glazed windows with the seamless look and style of a sashless window. Clearstep is ideal for colder climates and where high glazing levels are needed to meet energy rating requirements.

## Clearstep

### Double Glazed Sashless Double Hung Window

Finally a double glazed sashless window that actually looks like a sashless window!

Aneeta Windows identified the need for a double glazed double hung window that provides the "sashless" look.

AUS Patent No. 2005201474  
US Patent No. 7,716,875



## Task

The task was to use existing technology and create a double glazed unit without the aluminium capping on the insulated glass edges.

## Solution

The solution was to incorporate one of the double glazed panes with a **step** – where one piece of glass is longer than the other.

## Result

The result is an overlap of glass between the top and bottom panes. The aluminium interlocking rails were replaced with an extruded clear lap seal complete with weather-strip. End result – a double glazed sashless window that complements our 6mm and 10mm single glazed units.

## Providing

We provide an increased energy efficient double glazed unit by using our existing double glazed unit with the added feature of our new **Clearstep**.

## Specify

Be sure, clear and precise to demand "Aneeta Window Systems' Clearstep Double Glazed Sashless Window".

### Typical Configurations

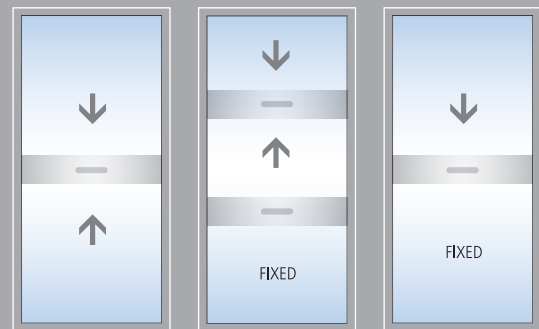

## Benefits

- Looks almost identical to our single glazed sashless windows
- Provides the "raw" industrial look preferred by designers
- Counterbalanced to maintain an easy opening operation
- Designed with the slimmest sash framing system available
- Provides a superior thermal performance
- Can be supplied in 3 pane and servery configurations
- Double Glazed units are designed around a 16mm overall size – which are suitable for glass sizes of:
  - 4 glass / 8 air (argon) / 4 glass
  - 4 glass / 6 air (argon) / 6 (6.38) glass.